

# DIMENSIONS SIZES 122-365 DWDI

## Arr.3

| FAN SIZE                |      | UNIFOIL  |          |          |          |          |          | ULTRAFOIL |         |         |         |          |          |
|-------------------------|------|----------|----------|----------|----------|----------|----------|-----------|---------|---------|---------|----------|----------|
|                         |      | 122      | 135      | 150      | 165      | 182      | 200      | 222       | 245     | 270     | 300     | 330      | 365      |
| Common Dimensions       | A    | 17.1     | 18.9     | 20.9     | 23.0     | 25.4     | 27.9     | 30.9      | 34.1    | 37.5    | 41.8    | 45.9     | 50.8     |
|                         | B    | 434      | 480      | 531      | 584      | 645      | 709      | 785       | 866     | 953     | 1062    | 1166     | 1290     |
|                         | C    | 1.5      | 1.5      | 1.5      | 1.5      | 2.0      | 2.0      | 2.0       | 1.9     | 2.5     | 2.5     | 2.5      | 2.5      |
|                         | D    | 38       | 38       | 38       | 38       | 51       | 51       | 51        | 48      | 64      | 64      | 64       | 64       |
|                         | E    | 7.3      | 7.3      | 7.5      | 7.6      | 8.3      | 8.3      | 8.8       | 10.0    | 11.1    | 11.3    | 12.3     | 12.8     |
|                         | F    | 185      | 185      | 191      | 193      | 211      | 211      | 224       | 254     | 282     | 287     | 313      | 325      |
| Top Horiz. Discharge    | G    | 13.4     | 14.8     | 16.4     | 18.0     | 19.9     | 21.8     | 24.1      | 26.6    | 29.4    | 32.6    | 35.9     | 39.6     |
|                         | H    | 340      | 376      | 417      | 457      | 505      | 554      | 612       | 676     | 747     | 828     | 912      | 1006     |
|                         | J    | 26.8     | 29.3     | 32.0     | 35.0     | 39.3     | 42.5     | 46.8      | 51.3    | 56.5    | 62.3    | 68.0     | 74.8     |
|                         | G    | 681      | 744      | 813      | 889      | 998      | 1080     | 1189      | 1303    | 1435    | 1582    | 1727     | 1900     |
|                         | H    | 23.5     | 25.5     | 27.9     | 30.4     | 34.3     | 37.1     | 40.8      | 44.5    | 48.6    | 53.6    | 58.5     | 64.3     |
|                         | J    | 597      | 648      | 709      | 772      | 871      | 942      | 1036      | 1130    | 1234    | 1361    | 1486     | 1633     |
| Bottom Horiz. Discharge | G    | 9.9      | 10.7     | 11.7     | 12.7     | 14.4     | 15.6     | 17.1      | 18.6    | 20.3    | 22.3    | 24.3     | 26.7     |
|                         | H    | 251      | 272      | 297      | 323      | 366      | 396      | 434       | 472     | 516     | 566     | 617      | 678      |
|                         | J    | 11.9     | 13.0     | 14.1     | 15.5     | 17.4     | 18.4     | 20.6      | 22.6    | 24.6    | 27.1    | 29.6     | 32.6     |
|                         | G    | 302      | 330      | 358      | 394      | 442      | 478      | 523       | 574     | 625     | 688     | 752      | 828      |
|                         | H    | 23.5     | 25.5     | 27.9     | 30.4     | 34.3     | 37.1     | 40.8      | 44.5    | 48.6    | 53.6    | 58.5     | 64.3     |
|                         | J    | 597      | 648      | 709      | 772      | 871      | 942      | 1036      | 1130    | 1234    | 1361    | 1486     | 1633     |
| Up Discharge            | G    | 11.9     | 13.0     | 14.1     | 15.5     | 17.4     | 18.8     | 20.6      | 22.6    | 24.6    | 27.1    | 29.6     | 32.6     |
|                         | H    | 302      | 330      | 358      | 394      | 442      | 478      | 523       | 574     | 625     | 688     | 752      | 828      |
|                         | J    | 13.6     | 14.8     | 16.2     | 17.7     | 19.8     | 21.6     | 23.7      | 25.9    | 28.3    | 31.3    | 34.2     | 37.6     |
|                         | G    | 345      | 376      | 411      | 450      | 503      | 549      | 602       | 658     | 719     | 795     | 869      | 955      |
|                         | H    | 26.8     | 29.3     | 32.0     | 35.0     | 39.3     | 42.5     | 46.8      | 51.3    | 56.5    | 62.3    | 68.0     | 74.8     |
|                         | J    | 681      | 744      | 813      | 889      | 998      | 1080     | 1189      | 1303    | 1435    | 1582    | 1727     | 1900     |
| Down Disch.             | G    | 11.9     | 13.0     | 14.1     | 15.5     | 17.4     | 18.8     | 20.6      | 22.6    | 24.6    | 27.1    | 29.6     | 32.6     |
|                         | H    | 302      | 330      | 358      | 394      | 442      | 478      | 523       | 574     | 625     | 688     | 752      | 828      |
|                         | J    | 9.9      | 10.7     | 11.7     | 12.7     | 14.4     | 15.6     | 17.1      | 18.6    | 20.3    | 22.3    | 24.3     | 26.7     |
|                         | G    | 251      | 272      | 297      | 323      | 366      | 396      | 434       | 472     | 516     | 566     | 617      | 678      |
|                         | H    | 26.8     | 29.3     | 32.0     | 35.0     | 39.3     | 42.5     | 46.8      | 51.3    | 56.5    | 62.3    | 68.0     | 74.8     |
|                         | J    | 681      | 744      | 813      | 889      | 998      | 1080     | 1189      | 1303    | 1435    | 1582    | 1727     | 1900     |
| Class 1                 | K    | 1-7/16   | 1-7/16   | 1-11/16  | 1-11/16  | 1-11/16  | 1-11/16  | 1-15/16   | 1-15/16 | 2-3/16  | 2-3/16  | 2-7/16   | 2-11/16  |
|                         | Kwy  | 37       | 37       | 43       | 43       | 43       | 43       | 49        | 49      | 56      | 56      | 62       | 68       |
| Class 2                 | K    | 3/8x3/16 | 3/8x3/16 | 3/8x3/16 | 3/8x3/16 | 3/8x3/16 | 3/8x3/16 | 1/2x1/4   | 1/2x1/4 | 1/2x1/4 | 1/2x1/4 | 5/8x5/16 | 5/8x5/16 |
|                         | Kwy  | 10x5     | 10x5     | 10x5     | 10x5     | 10x5     | 10x5     | 13x6.5    | 13x6.5  | 13x6.5  | 13x6.5  | 16x8     | 16x8     |
| Class 3                 | K    | 1-11/16  | 1-11/16  | 1-15/16  | 1-15/16  | 1-15/16  | 2-3/16   | 2-7/16    | 2-7/16  | 2-7/16  | 2-11/16 | 2-3/16   | 1-15/16  |
|                         | Kwy  | 43       | 43       | 49       | 49       | 49       | 56       | 62        | 62      | 62      | 68      | 56       | 49       |
| Fan Weights             | CI 1 | Lb       | 160      | 200      | 230      | 260      | 330      | 400       | 520     | 670     | 780     | 1100     | 1500     |
|                         | CI 2 | kg       | 73       | 91       | 104      | 118      | 150      | 181       | 236     | 304     | 354     | 499      | 680      |
|                         | CI 2 | Lb       | 220      | 250      | 270      | 320      | 390      | 470       | 650     | 790     | 980     | 1260     | 1580     |
|                         | CI 3 | kg       | 100      | 113      | 123      | 145      | 177      | 213       | 295     | 358     | 445     | 572      | 717      |
|                         | CI 3 | Lb       | -        | -        | -        | -        | -        | -         | -       | 1027    | 1274    | 1640     | 2470     |
|                         | CI 3 | kg       | -        | -        | -        | -        | -        | -         | -       | 466     | 578     | 744      | 1120     |

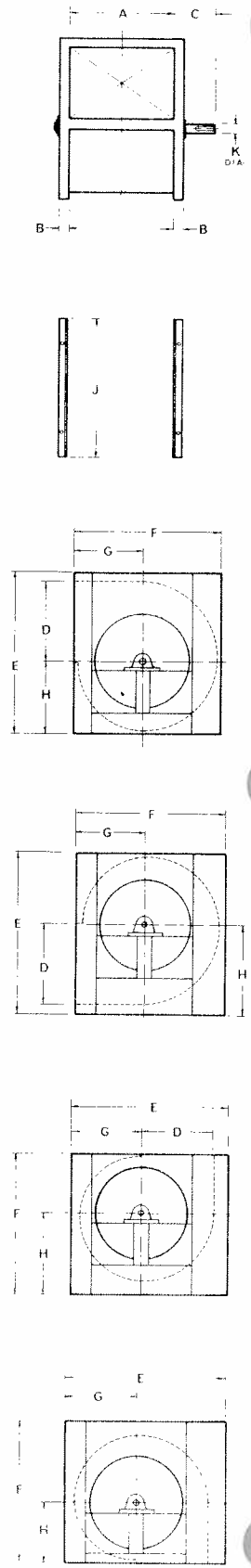

Dimensions - Inches - Black      Millimetres - Blue

NOTE: 1. Dimensions are applicable to Class 2 Units but apply generally to Class 1 and Class 3 also.  
 2. Certified dimension drawings available on request.  
 3. Fan weights are approximately correct and may be used for shipping and handling, and to calculate Vibration Isolators.

# DIMENSIONS

# SIZES 402-890 DWDI

# Arr.3

| FAN SIZE                    |      | 402                     | 445                     | 490                     | 542                     | 600                     | 660                     | 730                     | 807                     | 890                     |       |
|-----------------------------|------|-------------------------|-------------------------|-------------------------|-------------------------|-------------------------|-------------------------|-------------------------|-------------------------|-------------------------|-------|
| Common Dimensions           | A    | 56.3                    | 62.1                    | 68.5                    | 75.8                    | 83.8                    | 92.0                    | 102.0                   | 112.8                   | 124.0                   |       |
|                             | B    | 1430                    | 1577                    | 1740                    | 1925                    | 2128                    | 2337                    | 2590                    | 2865                    | 3150                    |       |
|                             | C    | 3.0                     | 3.5                     | 3.5                     | 3.5                     | 4.0                     | 4.0                     | 3.5                     | 3.5                     | 3.5                     |       |
|                             | D    | 76                      | 89                      | 89                      | 89                      | 102                     | 102                     | 89                      | 89                      | 89                      |       |
| Bottom Horizontal Discharge | E    | 12.3                    | 13.5                    | 13.3                    | 14.6                    | 14.6                    | 15.0                    | 16.3                    | 17.1                    | 22.0                    |       |
|                             | F    | 312                     | 343                     | 338                     | 371                     | 371                     | 381                     | 414                     | 434                     | 559                     |       |
|                             | G    | 43.8                    | 48.4                    | 53.1                    | 58.9                    | 65.0                    | 71.5                    | 79.1                    | 87.5                    | 96.5                    |       |
|                             | H    | 1113                    | 1229                    | 1349                    | 1496                    | 1651                    | 1816                    | 2009                    | 2223                    | 2451                    |       |
| Top Horizontal Discharge    | E    | 80.8                    | 88.8                    | 97.6                    | 107.4                   | 119.3                   | 131.3                   | 144.2                   | 159.7                   | 188.4                   |       |
|                             | F    | 2052                    | 2256                    | 2479                    | 2728                    | 3030                    | 3335                    | 3663                    | 4056                    | 4785                    |       |
|                             | G    | 69.7                    | 76.9                    | 84.2                    | 92.9                    | 102.9                   | 112.7                   | 124.1                   | 137.1                   | 151.5                   |       |
|                             | H    | 1770                    | 1953                    | 2139                    | 2357                    | 2614                    | 2863                    | 3152                    | 3482                    | 3848                    |       |
| Up Discharge                | E    | 30.5                    | 33.5                    | 36.5                    | 40.0                    | 44.5                    | 48.5                    | 53.0                    | 58.5                    | 66.0                    |       |
|                             | F    | 775                     | 851                     | 927                     | 1016                    | 1130                    | 1232                    | 1346                    | 1486                    | 1676                    |       |
|                             | G    | 56.0                    | 62.0                    | 67.0                    | 71.0                    | 80.0                    | 86.0                    | 92.0                    | 100.0                   | 110.0                   |       |
|                             | H    | 1422                    | 1575                    | 1702                    | 1803                    | 2032                    | 2184                    | 2337                    | 2540                    | 2794                    |       |
| Down Discharge              | E    | 78.7                    | 86.8                    | 95.6                    | 105.8                   | 116.8                   | 128.4                   | 142.0                   | 157.4                   | 174.3                   |       |
|                             | F    | 1999                    | 2205                    | 2428                    | 2687                    | 2967                    | 3261                    | 3607                    | 3998                    | 4427                    |       |
|                             | G    | 69.7                    | 76.9                    | 84.2                    | 92.8                    | 102.9                   | 112.7                   | 124.1                   | 137.1                   | 151.5                   |       |
|                             | H    | 1770                    | 1953                    | 2139                    | 2357                    | 2614                    | 2863                    | 3152                    | 3482                    | 3848                    |       |
| Class 1                     | E    | 71.0                    | 78.0                    | 85.5                    | 94.0                    | 104.5                   | 114.5                   | 126.0                   | 139.5                   | 155.8                   |       |
|                             | F    | 1803                    | 1981                    | 2172                    | 2388                    | 2654                    | 2908                    | 3200                    | 3543                    | 3957                    |       |
|                             | G    | 77.5                    | 85.6                    | 94.1                    | 104.3                   | 115.2                   | 126.7                   | 140.2                   | 155.1                   | 171.0                   |       |
|                             | H    | 1969                    | 2174                    | 2390                    | 2649                    | 2926                    | 3218                    | 3561                    | 3940                    | 4343                    |       |
| Class 2                     | E    | 30.5                    | 33.5                    | 36.5                    | 40.0                    | 44.5                    | 48.5                    | 53.0                    | 58.5                    | 66.0                    |       |
|                             | F    | 775                     | 851                     | 927                     | 1016                    | 1130                    | 1232                    | 1346                    | 1486                    | 1676                    |       |
|                             | G    | 56.0                    | 62.0                    | 67.0                    | 71.0                    | 80.0                    | 86.0                    | 92.0                    | 100.0                   | 110.0                   |       |
|                             | H    | 1422                    | 1575                    | 1702                    | 1803                    | 2032                    | 2184                    | 2337                    | 2540                    | 2794                    |       |
| Class 3                     | E    | 70.7                    | 77.9                    | 85.2                    | 93.8                    | 104.4                   | 114.2                   | 125.1                   | 138.1                   | 152.1                   |       |
|                             | F    | 1796                    | 1979                    | 2164                    | 2383                    | 2652                    | 2901                    | 3178                    | 3508                    | 3863                    |       |
|                             | G    | 77.5                    | 85.6                    | 94.1                    | 104.3                   | 115.2                   | 126.7                   | 140.2                   | 155.1                   | 171.0                   |       |
|                             | H    | 1969                    | 2174                    | 2390                    | 2649                    | 2926                    | 3218                    | 3561                    | 3940                    | 4343                    |       |
| Fan Weights                 | K    | 2-15/16                 | 1-15/16                 | 1-15/16                 | 2-3/16                  | 2-7/16                  | 2-7/16                  | 2-15/16                 | 2-15/16                 | 3-7/16                  |       |
|                             | Kwy  | 75<br>3/4x3/8<br>19x9.5 | 49<br>1/2x1/4<br>13x6.5 | 49<br>1/2x1/4<br>13x6.5 | 56<br>1/2x1/4<br>13x6.5 | 62<br>5/8x5/16<br>16x8  | 62<br>5/8x5/16<br>16x8  | 75<br>3/4x3/8<br>19x9.5 | 75<br>3/4x3/8<br>19x9.5 | 87<br>7/8x7/16<br>22x11 |       |
| Fan Weights                 | K    | 2-3/16                  | 2-3/16                  | 2-7/16                  | 2-11/16                 | 2-15/16                 | 2-15/16                 | 3-7/16                  | 3-7/16                  | 3-11/16                 |       |
|                             | Kwy  | 56<br>1/2x1/4<br>13x6.5 | 56<br>1/2x1/4<br>13x6.5 | 62<br>5/8x5/16<br>16x8  | 68<br>5/8x5/16<br>16x8  | 75<br>3/4x3/8<br>19x9.5 | 75<br>3/4x3/8<br>19x9.5 | 87<br>7/8x7/16<br>22x11 | 87<br>7/8x7/16<br>22x11 | 94<br>7/8x7/16<br>22x11 |       |
| Fan Weights                 | K    | 2-7/16                  | 2-11/16                 | 2-15/16                 | 2-15/16                 | 2-15/16                 | 3-7/16                  | 3-7/16                  | 3-11/16                 |                         |       |
|                             | Kwy  | 62<br>5/8x5/16<br>16x8  | 68<br>5/8x5/16<br>16x8  | 75<br>3/4x3/8<br>19x9.5 | 75<br>3/4x3/8<br>19x9.5 | 75<br>3/4x3/8<br>19x9.5 | 87<br>7/8x7/16<br>22x11 | 87<br>7/8x7/16<br>22x11 | 87<br>7/8x7/16<br>22x11 | 94<br>7/8x7/16<br>22x11 |       |
| Fan Weights                 | CI 1 | Lb                      | 2000                    | 2550                    | 3200                    | 3900                    | 4900                    | 6500                    | 8100                    | 10500                   | 13500 |
|                             |      | kg                      | 907                     | 1157                    | 1452                    | 1769                    | 2227                    | 2948                    | 3674                    | 4763                    | 6124  |
|                             | CI 2 | Lb                      | 2500                    | 3250                    | 4100                    | 4800                    | 6000                    | 7700                    | 9650                    | 15000                   | 18500 |
|                             |      | kg                      | 1133                    | 1477                    | 1860                    | 2177                    | 2722                    | 3493                    | 4377                    | 6804                    | 8392  |
|                             | CI 3 | Lb                      | 3250                    | 4230                    | 5330                    | 7540                    | 7800                    | 10010                   | 12550                   | 19500                   | 24050 |
|                             |      | kg                      | 1474                    | 1919                    | 2415                    | 3420                    | 3538                    | 4541                    | 5693                    | 8845                    | 10909 |

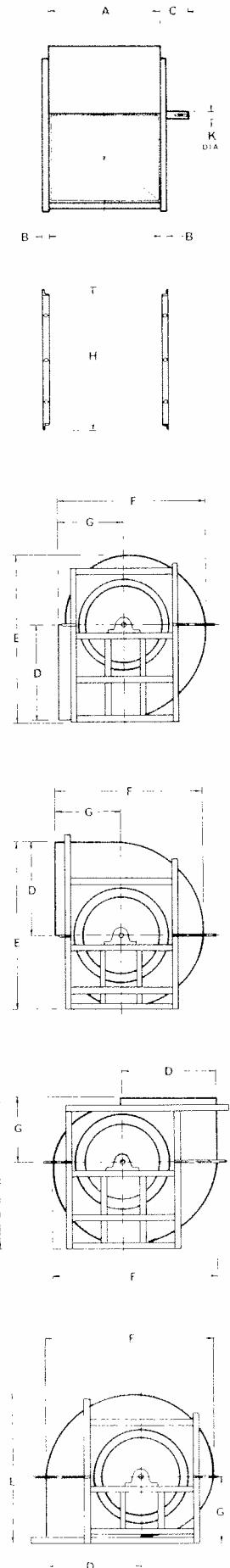

NOTE: 1. Dimensions are applicable to Class 3 Units, but apply generally to Class 1 and Class 2 also.  
 2. Certified dimension drawings available on request.  
 3. Unit Split as standard from size 660 and larger.  
 4. Fan weights are approximately correct and may be used for shipping and handling, and to calculate Vibration Isolators.

# DIMENSIONS

# SIZES 122-890 SWSI Arr.1&9

| FAN SIZE                 |      | UNIFOIL |       |       |       |       |       |       | ULTRAFOIL |       |       |       |       |       |       |       |       |       |       |       |       |       |       |
|--------------------------|------|---------|-------|-------|-------|-------|-------|-------|-----------|-------|-------|-------|-------|-------|-------|-------|-------|-------|-------|-------|-------|-------|-------|
|                          |      | 122     | 135   | 150   | 165   | 182   | 200   | 222   | 245       | 270   | 300   | 330   | 365   | 402   | 445   | 490   | 542   | 600   | 660   | 730   | 807   | 890   |       |
| Common Dimensions        | A    | 23.5    | 25.5  | 27.9  | 30.4  | 34.4  | 37.1  | 40.8  | 44.5      | 48.6  | 53.6  | 58.5  | 64.3  | 69.7  | 76.9  | 84.2  | 92.8  | 102.9 | 112.7 | 124.1 | 137.1 | 151.5 |       |
|                          | B    | 597     | 648   | 709   | 772   | 874   | 942   | 1036  | 1130      | 1234  | 1361  | 1486  | 1633  | 1770  | 1953  | 2139  | 2357  | 2614  | 2862  | 3152  | 3482  | 3848  |       |
|                          | C    | 26.8    | 29.3  | 32.0  | 35.0  | 39.3  | 42.5  | 46.8  | 51.3      | 56.5  | 62.3  | 68.0  | 74.8  | 80.8  | 88.8  | 97.6  | 107.4 | 119.3 | 131.3 | 144.2 | 159.7 | 188.4 |       |
|                          | D    | 696     | 744   | 775   | 800   | 927   | 960   | 1049  | 1057      | 1163  | 1245  | 1321  | 1422  | 1448  | 1562  | 1702  | 1839  | 1976  | 2134  | 2362  | 2616  | 3048  |       |
|                          | E    | 27.4    | 29.3  | 30.5  | 31.5  | 36.5  | 37.8  | 41.3  | 41.6      | 45.8  | 49.0  | 52.0  | 56.0  | 57.0  | 61.5  | 67.0  | 72.4  | 77.8  | 84.0  | 93.0  | 103   | 120   |       |
|                          | F    | 734     | 782   | 813   | 841   | 978   | 1011  | 1100  | 1140      | 1245  | 1346  | 1430  | 1537  | 1544  | 1641  | 1930  | 2042  | 2230  | 2423  | 2629  | 2860  | 3302  |       |
|                          | G    | 13.4    | 14.8  | 16.4  | 18.0  | 19.9  | 21.8  | 24.1  | 26.6      | 29.4  | 32.6  | 35.9  | 39.6  | 43.8  | 48.4  | 53.1  | 58.9  | 65.0  | 71.5  | 79.1  | 87.5  | 96.5  |       |
|                          | H    | 340     | 376   | 417   | 457   | 505   | 554   | 612   | 676       | 747   | 828   | 912   | 1006  | 1113  | 1229  | 1349  | 1456  | 1651  | 1816  | 2009  | 2223  | 2451  |       |
|                          | I    | 9.5     | 10.4  | 11.6  | 12.8  | 14.1  | 15.4  | 17.1  | 18.9      | 20.8  | 23.1  | 25.4  | 28.1  | 31.3  | 34.6  | 38.0  | 42.1  | 46.5  | 51.1  | 56.6  | 62.6  | 68.9  |       |
|                          | J    | 241     | 264   | 295   | 325   | 358   | 391   | 434   | 480       | 528   | 587   | 645   | 714   | 795   | 879   | 965   | 1069  | 1181  | 1298  | 1438  | 1590  | 1750  |       |
| K                        | 18.0 | 19.3    | 20.8  | 22.3  | 25.3  | 27.3  | 29.3  | 31.8  | 35.3      | 38.3  | 41.3  | 44.8  | 48.8  | 53.3  | 57.8  | 63.0  | 70.0  | 76.0  | 83.5  | 91.5  | 100.5 |       |       |
| L                        | 457  | 490     | 528   | 566   | 643   | 693   | 744   | 802   | 897       | 973   | 1049  | 1138  | 1240  | 1354  | 1469  | 1600  | 1778  | 1930  | 2121  | 2324  | 2553  |       |       |
| M                        | 1.5  | 1.5     | 1.5   | 1.5   | 2.0   | 2.0   | 2.0   | 1.9   | 2.5       | 2.5   | 2.5   | 2.5   | 3.0   | 3.5   | 3.5   | 3.5   | 4.0   | 4.0   | 3.5   | 3.5   | 3.5   |       |       |
| N                        | 38   | 38      | 38    | 38    | 51    | 51    | 51    | 48    | 64        | 64    | 64    | 64    | 76    | 89    | 89    | 89    | 102   | 102   | 99    | 89    | 99    |       |       |
| O                        | 12.0 | 13.0    | 14.0  | 15.0  | 17.0  | 18.0  | 20.0  | 22.0  | 24.0      | 27.0  | 29.0  | 32.0  | 40.5  | 46.5  | 51.5  | 55.5  | 58.0  | 64.0  | 68.0  | 72.0  | 76.0  |       |       |
| P                        | 508  | 533     | 533   | 533   | 617   | 668   | 668   | 635   | 643       | 711   | 749   | 787   | 724   | 775   | 826   | 1003  | 907   | 927   | 1049  | 1151  | 1410  |       |       |
| Q                        | 20.0 | 21.0    | 21.0  | 21.0  | 24.3  | 26.3  | 26.3  | 25.0  | 25.3      | 28.0  | 29.5  | 31.0  | 28.5  | 30.5  | 32.5  | 39.5  | 35.3  | 36.5  | 41.3  | 45.3  | 55.5  |       |       |
| R                        | 546  | 574     | 574   | 572   | 668   | 676   | 719   | 719   | 775       | 815   | 866   | 904   | 826   | 861   | 1054  | 1207  | 1151  | 1219  | 1316  | 1392  | 1664  |       |       |
| Top Horizontal Discharge | L    | 9.9     | 10.7  | 11.7  | 12.7  | 14.4  | 15.6  | 17.1  | 18.6      | 20.3  | 22.3  | 24.3  | 26.7  | 30.5  | 33.5  | 36.5  | 40.0  | 44.5  | 48.5  | 53.0  | 58.5  | 66.0  |       |
|                          | M    | 251     | 272   | 297   | 323   | 366   | 396   | 434   | 472       | 516   | 566   | 617   | 679   | 775   | 851   | 927   | 1016  | 1130  | 1232  | 1346  | 1486  | 1676  |       |
|                          | N    | 11.9    | 13.0  | 14.1  | 15.5  | 17.4  | 18.8  | 20.6  | 22.6      | 24.6  | 27.1  | 29.6  | 32.6  | 35.0  | 38.5  | 42.5  | 47.0  | 52.0  | 57.0  | 63.0  | 70.0  | 77.8  |       |
| Bottom Horiz. Discharge  | L    | 9.9     | 10.7  | 11.7  | 12.7  | 14.4  | 15.6  | 17.1  | 18.6      | 20.3  | 22.3  | 24.3  | 26.7  | 30.5  | 33.5  | 36.5  | 40.0  | 44.5  | 48.5  | 53.0  | 58.5  | 66.0  |       |
|                          | M    | 14.9    | 16.3  | 17.9  | 19.5  | 21.9  | 23.8  | 26.1  | 28.6      | 31.9  | 35.0  | 38.0  | 42.5  | 47.0  | 51.5  | 56.5  | 62.0  | 69.0  | 76.0  | 83.0  | 92.0  | 101.0 |       |
|                          | N    | 378     | 414   | 455   | 495   | 556   | 605   | 663   | 726       | 810   | 889   | 965   | 1080  | 1194  | 1308  | 1436  | 1575  | 1753  | 1930  | 2108  | 2337  | 2565  |       |
| Class 1                  | K    | 1 1/8   | 1 1/8 | 1 1/8 | 1 1/8 | 1 1/8 | 1 1/8 | 1 1/8 | 1 1/8     | 1 1/8 | 1 1/8 | 1 1/8 | 1 1/8 | 2 1/8 | 2 1/8 | 2 1/8 | 2 1/8 | 2 1/8 | 2 1/8 | 2 1/8 | 3 1/8 |       |       |
|                          | kwy  | 30      | 30    | 30    | 37    | 37    | 37    | 37    | 37        | 37    | 43    | 43    | 49    | 49    | 56    | 56    | 62    | 68    | 68    | 68    | 68    | 81    |       |
| Class 2                  | K    | 1 1/8   | 1 1/8 | 1 1/8 | 1 1/8 | 1 1/8 | 1 1/8 | 1 1/8 | 1 1/8     | 1 1/8 | 2 1/8 | 2 1/8 | 2 1/8 | 2 1/8 | 2 1/8 | 2 1/8 | 2 1/8 | 2 1/8 | 2 1/8 | 2 1/8 | 3 1/8 |       |       |
|                          | kwy  | 10x5    | 10x5  | 10x5  | 10x5  | 10x5  | 10x5  | 10x5  | 10x5      | 10x5  | 10x5  | 10x5  | 10x5  | 10x5  | 10x5  | 10x5  | 10x5  | 10x5  | 10x5  | 10x5  | 10x5  | 10x5  |       |
| Class 3                  | K    | 1 1/8   | 1 1/8 | 1 1/8 | 1 1/8 | 1 1/8 | 1 1/8 | 1 1/8 | 1 1/8     | 2 1/8 | 2 1/8 | 2 1/8 | 2 1/8 | 2 1/8 | 2 1/8 | 2 1/8 | 2 1/8 | 2 1/8 | 2 1/8 | 2 1/8 | 3 1/8 |       |       |
|                          | kwy  | 49      | 56    | 56    | 62    | 62    | 62    | 62    | 62        | 62    | 62    | 62    | 62    | 62    | 62    | 62    | 62    | 62    | 62    | 62    | 62    | 81    |       |
| Fan Weights              | CI 1 | Lb      | 160   | 180   | 220   | 260   | 310   | 390   | 490       | 620   | 740   | 950   | 1160  | 1340  | 1630  | 2030  | 2550  | 3330  | 4010  | 4810  | 6160  | 8270  | 11100 |
|                          |      | Kg      | 73    | 82    | 100   | 118   | 141   | 177   | 222       | 281   | 336   | 431   | 526   | 608   | 739   | 921   | 1157  | 1511  | 1819  | 2182  | 2794  | 3751  | 5035  |
|                          | CI 2 | Lb      | 170   | 220   | 270   | 320   | 380   | 430   | 570       | 730   | 880   | 1080  | 1290  | 1550  | 1950  | 2440  | 3030  | 3650  | 4660  | 5810  | 7260  | 9520  | 12150 |
|                          | Kg   | 77      | 100   | 123   | 145   | 172   | 195   | 259   | 331       | 390   | 490   | 585   | 703   | 885   | 1107  | 1374  | 1656  | 2114  | 2635  | 3293  | 4318  | 5511  |       |
| CI 3                     | Lb   | --      | --    | --    | --    | --    | --    | --    | 950       | 1140  | 1400  | 1670  | 2015  | 2535  | 3170  | 3940  | 4750  | 6060  | 7550  | 9440  | 12380 | 15800 |       |
|                          | Kg   | --      | --    | --    | --    | --    | --    | --    | 431       | 517   | 635   | 758   | 914   | 1150  | 1438  | 1787  | 2155  | 2749  | 3425  | 4282  | 5616  | 7167  |       |

Dimensions - Inches - Black      Millimetres - Blue

NOTE:-

1. Dimensions are applicable to Class 2 Units but apply generally to Class 1 and Class 3 also.
2. Certified dimension drawings available on request.
3. Unit Split as standard from size 660 and larger.
4. Fan weights are approximately correct and may be used for shipping and handling and to calculate Vibration Isolators. Note, motor weights are not included.

